

WHERE LIFE GETS THE BEST OF LUXURY & LOCALE



SIDDHIVINAYAK

PRATIMA

NEXT TO KHARGHAR



Artist's Impression

NEAR PROPOSED PENDHAR METRO STATION

The Project has been registered via MAHARERA Registration Number **P52000015123** and is available on the website <https://maharera.mahaonline.gov.in> under registered projects.



Imagine an environ that enchants your senses while you adore the comforts of home. A place where you can go beyond living. Here's to your imagination. Presenting the world of Siddhivinayak Pratima. A perfect harmony between the luxury of a home with the beauty and allure of nature. Set in the lap of serenity, the excellence of Pratima enriches and recreates the grandeur that inspires an extraordinary living. Come, make your home the best place to celebrate life.

KEY PROJECT HIGHLIGHTS



Clubhouse
with Gym



Swimming Pool
with Kids Pool



Badminton
Court



Garden Area



Commercial
Shops



Sitout Area



Children's
Play Area



Jogging Track

Images are for representational purpose only

MASTER PLAN LAYOUT



TYPICAL UNIT PLAN
2 ROOM APARTMENTS

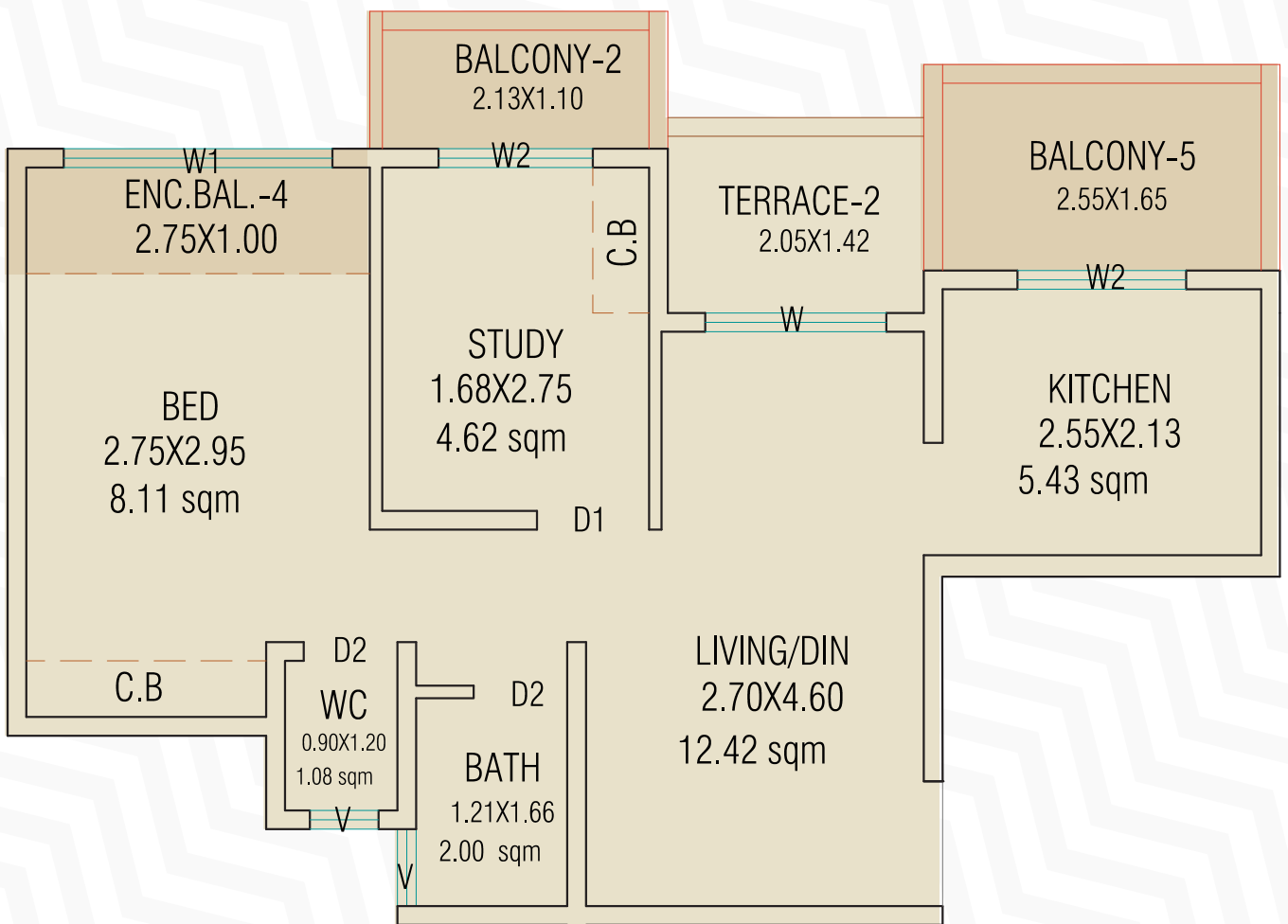

TYPICAL UNIT PLAN
1 ROOM APARTMENTS

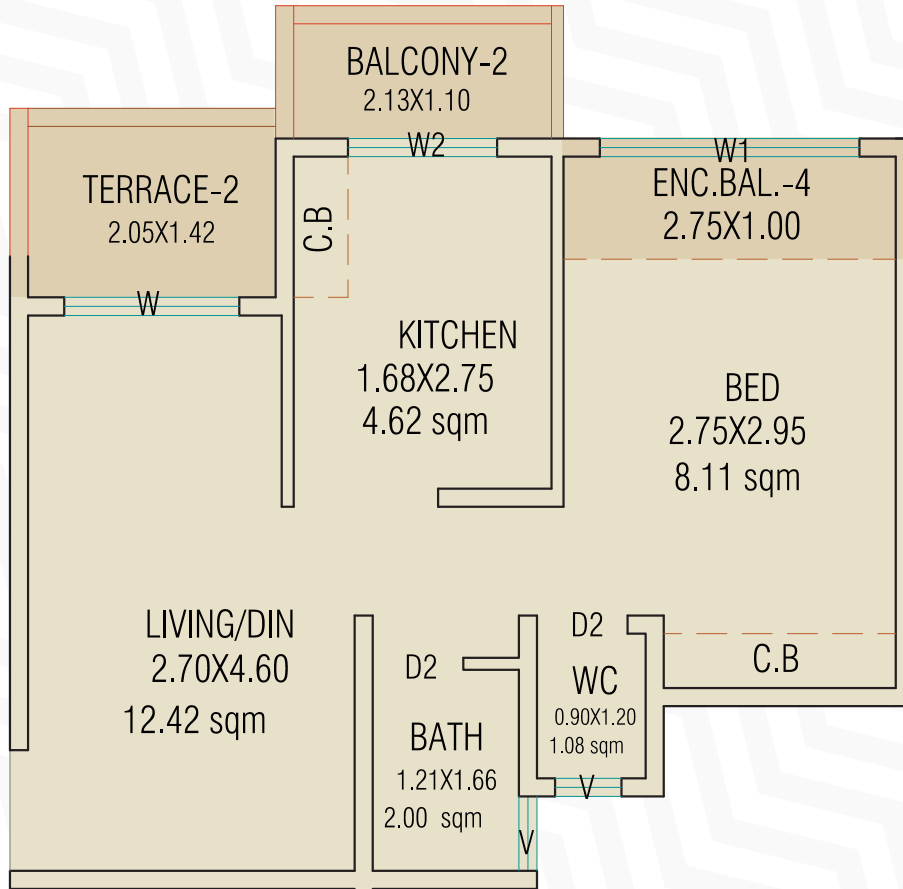

TYPICAL UNIT PLAN
STUDIO APARTMENTS

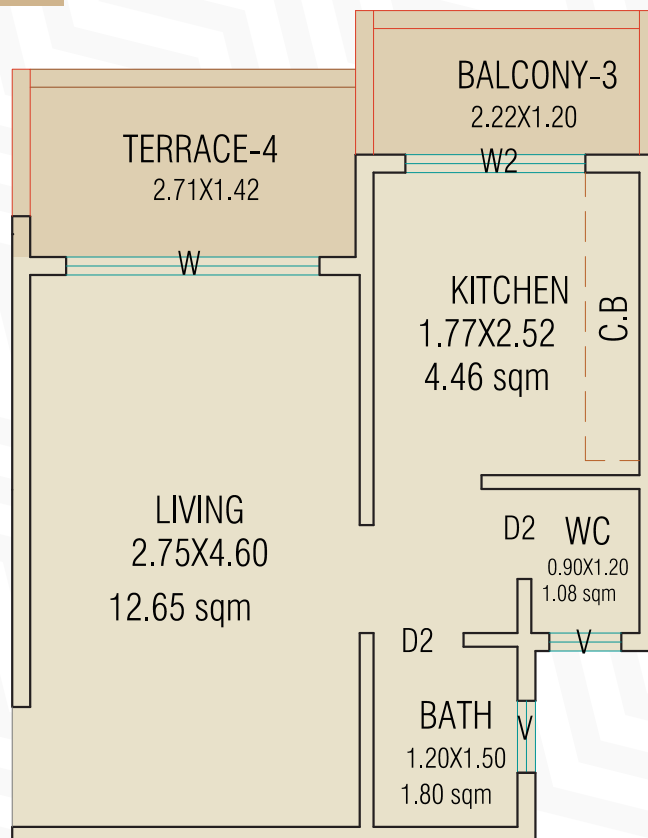



LOCATION HIGHLIGHTS



5 MINS. WALK TO
PROPOSED PENDHAR
METRO STATION



10 MINS.
DRIVE TO
CENTRAL PARK



10 MINS. DRIVE TO
GOLF COURSE,
KHARGHAR



10 MINS. DRIVE TO
TALOJA
RAILWAY STATION

A project by

**SIDDHIVINAYAK
HOMES**
A signature of trust

SIDDHIVINAYAK PRATIMA

Site Address: Survey No. 1/6/10, 1/6/11, 1/6/12, 1/6/13, Koynavele, Talaja, Panvel, Raigad - 410 208

Corporate Address: Plot No 35, Opp. Ganesh Mandir, Sector 5, Kharghar, Navi Mumbai - 410 210

Email: Info@siddhivinayakhomes.co.in

CALL: 96999 00600

Disclaimer: The information, specifications, amenities, layout, pictures etc. shown/contained in this brochure are indicative only. The Builder/Developer shall not be liable, responsible, obligated and/or required to provide any/all such amenities, specifications etc. as contained in this brochure. All plans, drawings, information, specification, amenities, layout etc. are subject to approval from local government authorities & Municipal Corporation. The Builder/Developer shall have irrevocable and unconditional right to change, delete, substitute, alter, subtract, add, amend etc. the said plans, drawings, information, specifications, amenities, layout etc., in such manner as the Builder/Developer may deem fit. No right of any nature whatsoever shall be constructed and/or deemed to have accrued in favour of any person and/purchaser of the premises from or by virtue of this brochure. The Builder/Developer shall not be liable and/or responsible for any loss, damages, cost, charges, expenses suffered/incurred and/or likely to be suffered and/or incurred by any person and/or purchasers of the premises. No person or purchaser of the premises shall have any right to be entitled claim or enforce any right based on this brochure.